

BMW Group - AIR: 2023-08-01 / 17:32

Dealer: 32711/06

Model: X3 M40i

Development code: G01

Model code: 83DP

Lead type: 83DP

---

[Oil change in the rear axle differential including used oil disposal](#) »

### WARNING

**Hot fluids.**

**Risk of scalding!**

- Conduct all work in the vehicle wearing appropriate personal protective equipment only.

### WARNING

**Contact with hazardous fluids.**

**Hazardous to health!**

- Note and follow safety instructions on containers.
- Conduct all work in appropriate personal protective equipment only.

### RISK OF DAMAGE

**Damage to rear axle differential.**

**Failure to comply with the oil specifications can result in serious damage to the rear axle differential.**

- After completion of repair work, check the transmission oil level in the rear axle differential.
- Use only the approved final drive transmission oil.

### TECHNICAL INFORMATION

Collect and dispose of emerging fluids. Observe country-specific waste disposal regulations.

## Main Works

### Drawing off oil in the rear axle differential

#### CAUTION

Contact with hazardous substances.

Health impairment.

- Note and comply with the Safety Instructions on the containers and the instructions on the manufacturer's safety data sheet.
- Conduct all work in appropriate personal protective equipment only.

#### CAUTION

Acid combustions may result from skin contact with oil or inhaling oil vapors.

Risk of acid burns from contact with oil!

- Wear safety goggles and hand protection.
- Ensure sufficient ventilation.

#### NOTE

Schematic diagram is for example purposes. Some parts may differ in certain details.



- Use the special tool **0 493 337 (00 2 080)** for drawing off the rear differential fluid.

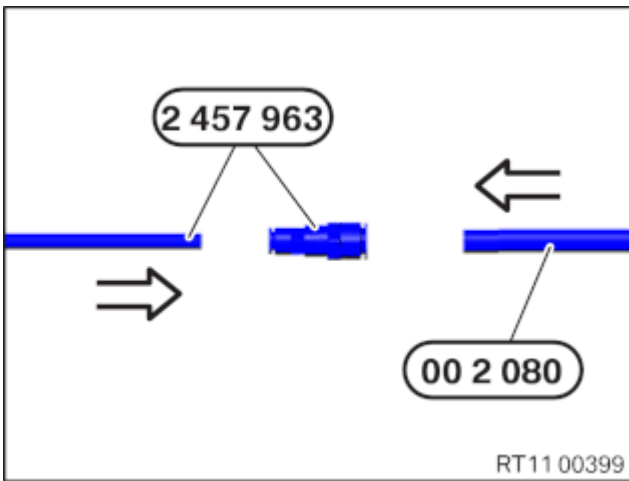

- Connect the special tool 2 457 963 with the special tool 0 493 337 (00 2 080).

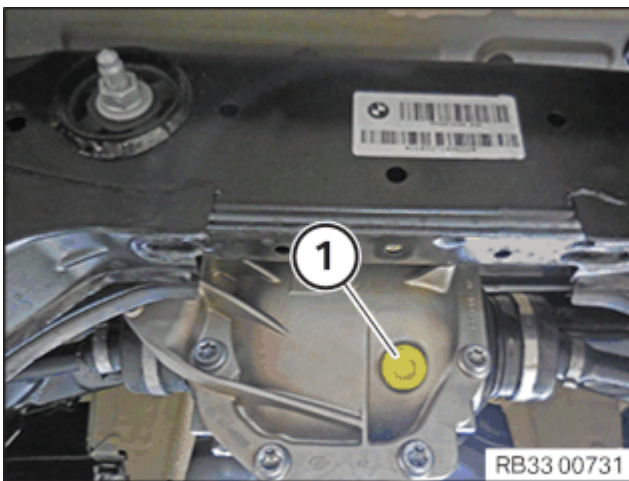

- Open the oil filler plug (1).
- Draw off rear axle differential oil.

## Ölniveau im Hinterachsgetriebe prüfen/ergänzen

Further information is available.



### RISK OF DAMAGE

Damage to rear axle differential.

Failure to comply with the oil specifications can result in serious damage to the rear axle differential.

- Only use approved oil in the rear axle differential.



### TECHNICAL INFORMATION

Collect and dispose of emerging fluids. Observe country-specific waste disposal regulations.

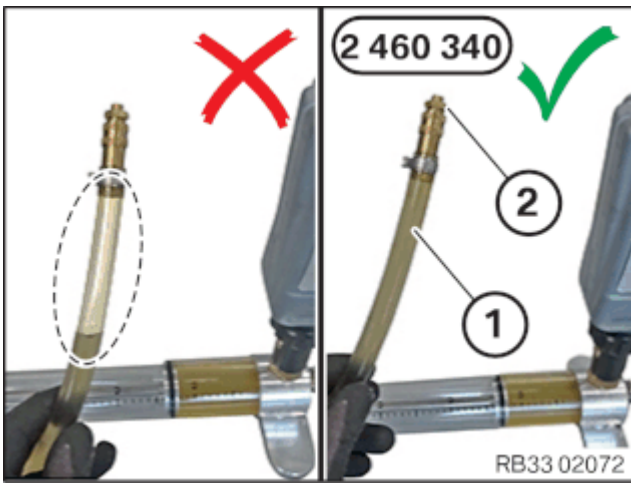

## **i** TECHNICAL INFORMATION

It is imperative to ensure that there is no air in the hose when topping up a defined (measured) oil quantity.

- Spezialwerkzeug **2 460 340** zum Auffüllen verwenden.
- Beim Auffüllen einer definierten (abgemessenen) Ölmenge, den Schlauch (1) zuerst mit Öl befüllen. Dazu einen Adapter (2) aufstecken.

### ► Supplement the rear differential fluid change/oil level with oil gun

## **i** TECHNICAL INFORMATION

The training video provides a schematic view of the method for changing the rear axle differential oil using the oil spray nozzle special tool.

The training video does not replace the repair instructions.

The training video is not subject to the update service.

We can assume no liability for printing errors or inaccuracies in this document and reserve the right to introduce technical modifications at any time.

- Follow repair instructions!



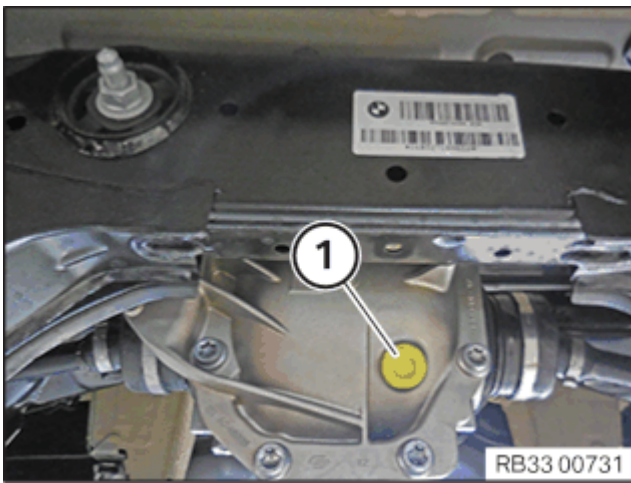

- Öleinfüllschraube (1) lösen.
- Ölniveau prüfen.

Das Ölniveau im Hinterachsgetriebe ist korrekt eingestellt, wenn an der Öffnung der Öleinfüllschraube etwas Öl austritt.

Ggf. Hinterachsgetriebeöl auffüllen.

#### Technical data

##### Füllmengen Hinterachsgetriebeöl ohne Hinterachsgetriebesperre

Vor Gebrauch schütteln (mischen).	<b>168LW</b>	0,75 l
	<b>190AL</b>	0,8 l
	<b>205AL</b>	0,8 l
	<b>215LW</b>	0,9 l
	<b>225AL</b>	0,9 l
	<b>235LK</b>	1,2 l

#### Technical data

##### Füllmengen Hinterachsgetriebeöl mit Hinterachsgetriebesperre

Vor Gebrauch schütteln (mischen).	<b>215LWS</b>	1,0 l
	<b>225ALS</b>	1,0 l
	<b>225M</b>	1,0 l
	<b>235M</b>	1,4 l

- Öleinfüllschraube (1) erneuern.
- Teile: Öleinfüllschraube
- Öleinfüllschraube (1) einschrauben und festziehen.

#### Tightening torques

Rear differential fluid filler plug

M22

Renew the oil filler  
plug.

tightening torque

60Nm